

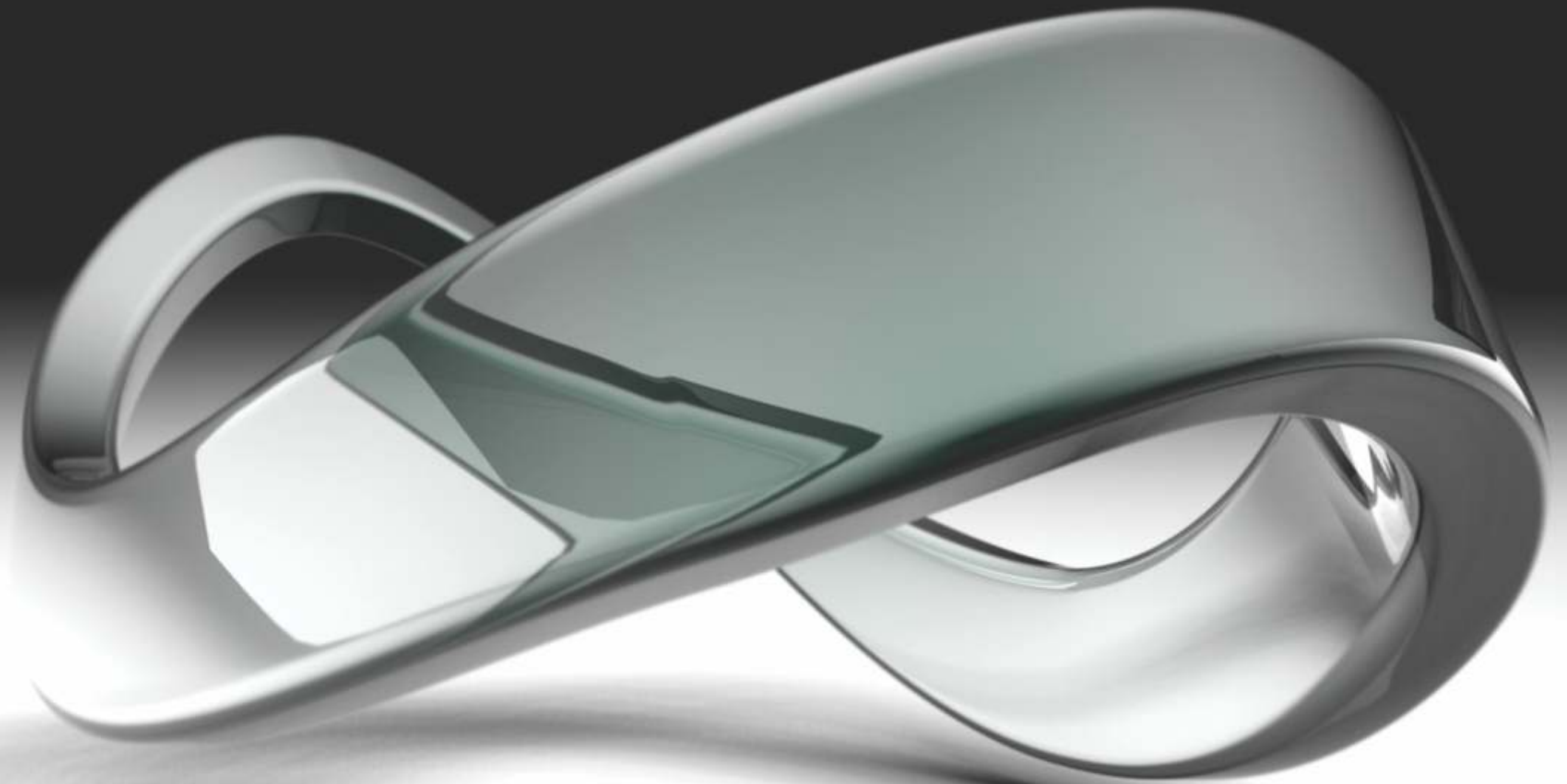

LUXURY ... UNLIMITED





EXHALE THE ANXIETIES OF CITY LIFE AND RELAX

When life is offered with a perfect balance of harmony and luxury, it just feels so complete. And when it is complemented by a large expanse of magical seclusion and modern comforts, the result is pure serenity.

Your home is your haven from the world of chaos. A place where you can go to rest, relax and dream of your accomplishments. Nothing is more blissful than lying down on a fluffy bed and drifting off from the complexities of daily life. Rejuvenating each moment in lush greens and being spoilt with thoughtful amenities that makes living life, even more beautiful.

You can now live in peaceful, luxurious and calm surroundings that will make you feel refreshed every morning, instead of hiding under the covers of pollution. Live in INFINITI HOMES.





VISION
Infiniti Homes
Luxury Villas @ Tellapur, Hyderabad



THE BEAUTIFUL SIDE

Sequestered at Tellapur, Hyderabad in an expanse of 23 acres of magical seclusion, is Infiniti Homes - your ultimate destination in luxury living. A community of 107 luxury villas, Infiniti Homes is nestled within a plush community, surrounded by emerald green fairways and offers some of the finest world class facilities.

The villa is conceived to exist in perfect harmony within natural surroundings. An American Inspired layout creates a seamless marriage between indoor and outdoor living environments all the time, maintaining complete privacy through dramatic and classy landscaping.

Enjoy beautiful vistas of the surrounding nature all day long, with plenty of space for large family gatherings or to find your own quite corner. The exquisitely styled interiors portrays pure Italian marble flooring and highest quality Balارشah Teak wood that are totally unmatched by any other.





ABUNDANCE OF LUXURY

The spacious layout at Infiniti Homes maintains a premium feel, which allows total relaxation in the comfort of your personal Villa.

A private entrance leads up to your personal pad with uninterrupted views of the lush surroundings of nature.

Infiniti Homes features spacious living, drawing, dining areas and sizeable western kitchens which blend with the large outdoor area of your home. The master and other bedrooms lead you to a private terrace where you can enjoy breakfast or relax watching serene surroundings.

Your own personal theatre packs a punch with rich feel of royalty and comfort.

A separate entrance to the servant quarters with attached bath keeps you away from unwanted disturbances.





THOUGHTFUL NECESSITIES

Infiniti Homes is not just big on luxury, it is as big on its civic facilities and infrastructure as well. Thoughtful detailing has been given to each civic amenity to make sure you are supported with plenty of basic requirements. Not just that, stringent security measures and elegant comforts make sure all your necessities are totally taken care of.

HIGHLIGHTS:

- Well designed internal cables for Electricity, Television and Communication Systems.
- Cambered BT roads with surface drains along concrete kerb stones.
- Opening to an expanse of greenery by open walkways.
- Round the clock water supply.
- Gated community surrounded with solar security fencing all around the compound wall, apart manned security for extra safety.
- Water treatment plant, Designer street lighting, Sewerage treatment plant, 100% Standby power supply, Rainwater harvesting pits, Visitor's parking area, Exquisite landscaping water bodies, Fountains, Lavish garden and jogging/walking track are provided.





UNWIND

Escape, relax. Secluded in the quietest part of the community, this sensual place of relaxation offers an array of facilities to help soothe the body, mind and soul.

Enjoy a full selection of high quality weights, cardio machines and exercise equipment assisted by personal trainers to ensure that every training and exercise need is fulfilled.

Luxurious loungers and the nearby community gardens will ensure you enjoy a exhilarating and memorable experience.

ADDED LUXURIES

- Swimming pool
- Health club
- Jacuzzi and Steam bath
- Squash courts
- Billiards and Table tennis
- Lawn tennis court
- Shuttle court
- Library, coffee shop
- Meditation hall and yoga center
- Air Conditioned guest rooms
- Multipurpose banquet hall with lawns
- Childrens play area with playpen.





As a community at Infiniti Homes, you can expect to get-together with warm cultured and like-minded families who have a zeal for living life upto the fullest.

Envisaged as a premium luxury pad for top corporate heads and affluent businessmen alike, Infiniti Homes is all about opulence, safety and unmatched panache.





VILLA **A** TYPE
460.00 Sq.yds. (3800.00 Sft.)
NORTH FACING UNIT



VILLA **B** TYPE
575.00 Sq.yds. (4500.00 Sft.)
EAST FACING UNIT



Ground Floor Plan

Plot Area	: 460.00 Sq.yds.
Ground Floor Area:	1660.00 Sft.
First Floor Area :	1900.00 Sft.
Total Area :	3415.00 Sft.
Portico Area :	240.00 Sft.
Total Area :	3800.00 Sft.



First Floor Plan



Plot Area	: 575.00 Sq.yds.
Ground Floor Area:	1973.00 Sft.
First Floor Area :	2222.00 Sft.
Total Area :	4065.00 Sft.
Portico Area :	305.00 Sft.
Total Area :	4500.00 Sft.



Ground Floor Plan





VILLA B TYPE
575.00 Sq.yds. (4500.00 Sft.)
WEST FACING UNIT



VILLA B TYPE
575.00 Sq.yds. (4500.00 Sft.)
NORTH FACING UNIT



Ground Floor Plan

Plot Area	: 575.00 Sq.yds.
Ground Floor Area:	1973.00 Sft.
First Floor Area :	2222.00 Sft.
Total Area :	4065.00 Sft.
Portico Area :	305.00 Sft.
Total Area :	4500.00 Sft.



First Floor Plan



Ground Floor Plan

Plot Area	: 575.00 Sq.yds.
Ground Floor Area:	1973.00 Sft.
First Floor Area :	2222.00 Sft.
Total Area :	4065.00 Sft.
Portico Area :	305.00 Sft.
Total Area :	4500.00 Sft.



First Floor Plan





VILLA **B** TYPE
575.00 Sq.yds. (4500.00 Sft.)
NORTH FACING UNIT



VILLA **A** TYPE
460.00 Sq.yds. (3655.00 Sft.)
SOUTH FACING UNIT



Ground Floor Plan

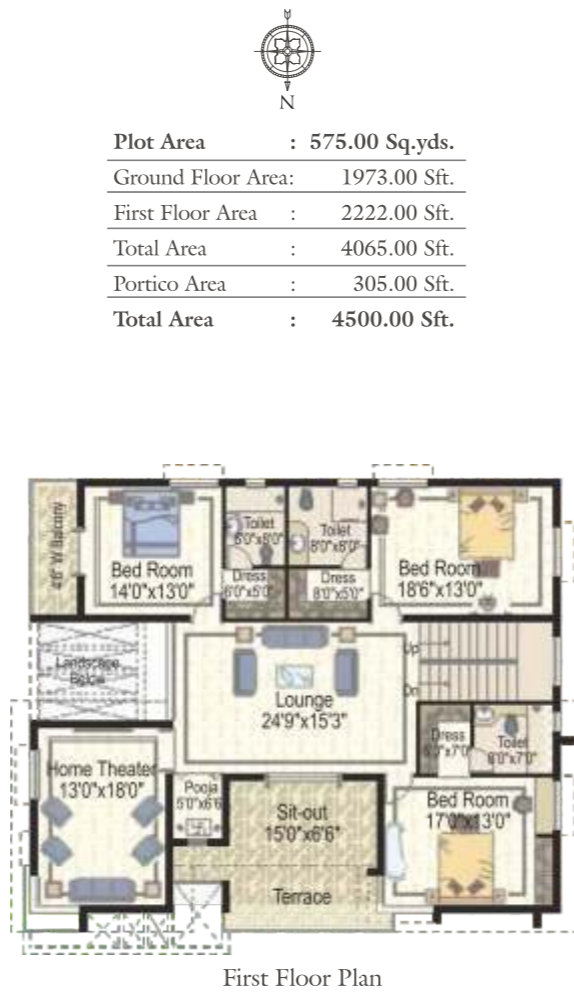

First Floor Plan

Plot Area	: 575.00 Sq.yds.
Ground Floor Area:	1973.00 Sft.
First Floor Area :	2222.00 Sft.
Total Area :	4065.00 Sft.
Portico Area :	305.00 Sft.
Total Area :	4500.00 Sft.



Ground Floor Plan



First Floor Plan

Plot Area	: 460.00 Sq.yds.
Ground Floor Area:	1660.00 Sft.
First Floor Area :	1755.00 Sft.
Total Area :	3415.00 Sft.
Portico Area :	240.00 Sft.
Total Area :	3655.00 Sft.





SHEET NO. 1 of 46



Cocooned amidst nature, yet infinitely convenient

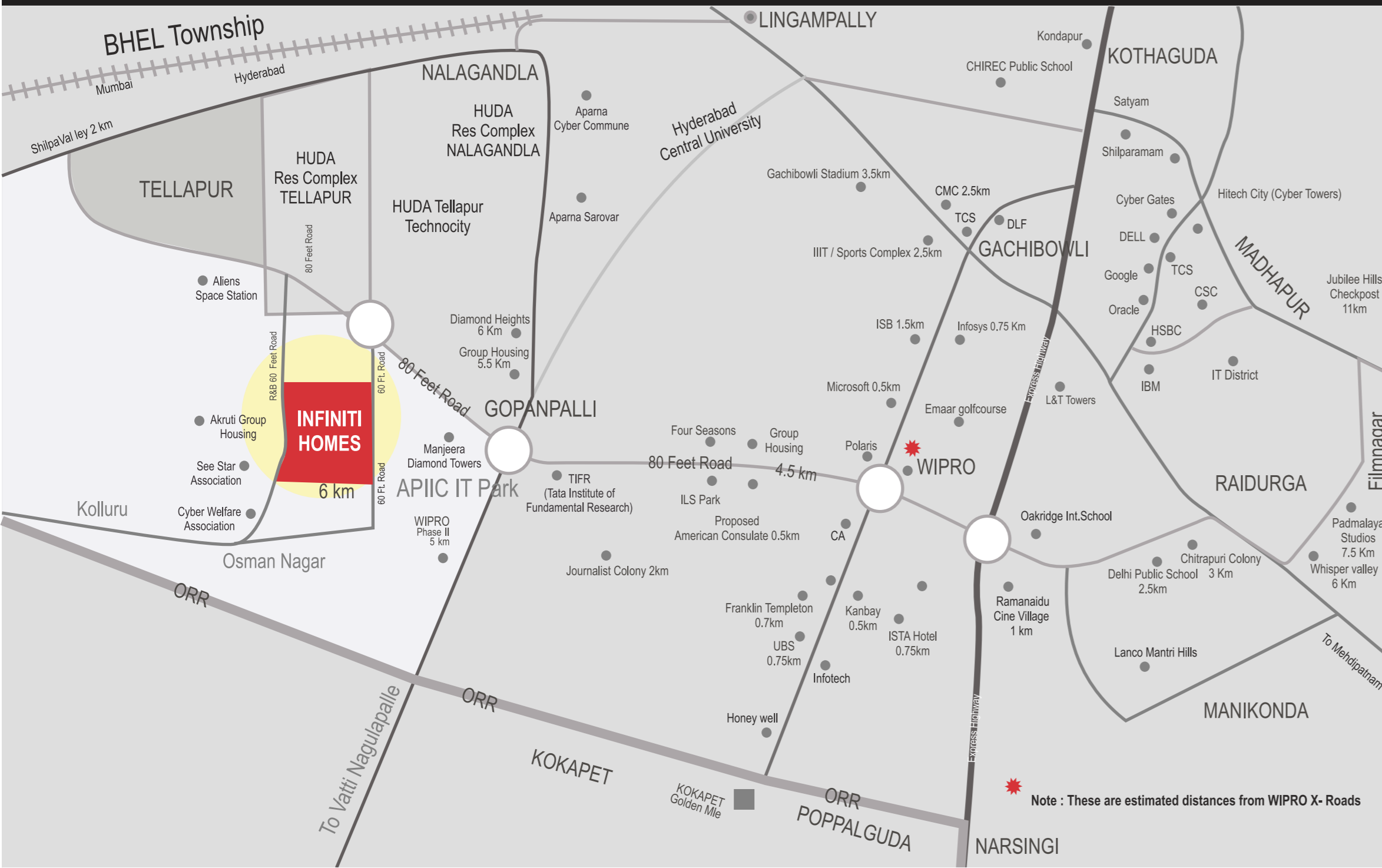

LOCATION PLAN (not to scale)

PRIME LOCATION

Located just 6kms away from the IT Hub of Gachibowli is Infiniti Homes. Not only that, top international schools, shopping malls and entertainment centers are just a short drive away.

Also with Gachibowli gaining in prominence and the nearby outer ring road connecting the community with the international airport, you just cant be better placed than this.

The software hub of Wipro, Infosys as well as the new campus of CA and Franklin Templeton are well within vicinity . Soon when the US Consulate opens its door at Gachibowli, so will the eyes of the world.



S P E C I F I C A T I O N S

FOUNDATION & STRUCTURE

RCC framed structure to withstand seismic loads for Zone-II

SUPER STRUCTURE

Brick masonry with first class table molded light weight bricks in cement mortar.

PLASTERING

Internal: 15mm thick double coat cement plaster smooth finishing
Ceiling: 12mm thick double coat cement plaster smooth finishing
External: 20mm thick double coat cement plaster smooth finishing

DOORS:

Main door: B T wood door frame & shutter with vision panel. Front side aesthetically designed with melamine polishing and designer hardware of reputed make.
Internal door: B.T wood frame & solid core flush shutter with one side veneer polished and other side synthetic enamel paint of reputed makes and standard hardware.

WINDOWS:

Window frames & shutters in B T Wood (polished inside & Outside painted) with glass paneled glazed shutters & provision for mosquito mesh fitted with elegantly designed M S grills with standard hardware.

AIR CONDITIONERS:

Split A/C provision for all bedrooms and halls.

PAINTING:

Internal: Smooth finish with luppum or equivalent over a coat of primer and top finish with two coats of plastic emulsion paint over a pop/ gypsum plaster.

Ceiling: Smooth finish with luppum or equivalent over a coat of primer and top finish with two coats of plastic emulsion paint.
External: Premium exterior texture emulsion paint of Renova /Spectrum or equivalent make.

FLOORING:

Drawing, Dining, Living Foyer& Staircase: Imported marble slabs with 4" height skirting

Bedrooms: Imported marble tiles with 4" height skirting

Kitchen: Best quality vitrified porcelain tiles in size 24"X24" with 4" height skirting.

Toilets/Utility area: Best quality acid resistant anti skid ceramic tiles

Covered Terrace & Balconies: Best quality rustic series ceramic tiles

TILES CLADDING & DADOING:

Kitchen Platform: Glazed ceramic tile dado up to 2'0" height, above kitchen platform.

Toilets: Designer make glazed ceramic tile dado up to 7'0" height toilets

Utility/Wash: Glazed ceramic tile dado up to 3'0" height.

KITCHEN:

Granite platform with cerasil sink with both Municipal & bore water connection and provision for fixing aqua guard.

Provision for exhaust fan and chimney.

Upgradable to designer modular kitchen at extra cost

Piped gas

WATER SUPPLY & SANITARY SYSTEMS.

Water supply points in kitchen/ toilets as required

Municipal water supply connection provision in kitchen from elevated tank

Separate water meter for individual units.

UTILITIES/WASH:

Provision for washing machine dish washer and wet area for washing utensils etc.

TOILETS:

All the toilets will consists of

- Imported marble counter top wash basin with hot and cold basin mixer valve.
- Cascade EWC with health faucet.
- Hot and cold wall mixer with shower
- Bath tub provision for master bedroom
- Provision for geysers in all toilets
- All C P fittings are chrome plated of GROHE or equivalent make.

ELECTRICAL SYSTEMS:

Concealed copper wiring in conduits for lights, fans, plug and power plug.
Points wherever necessary of finolex/ anchor or equivalent make.

- Power outlets for geysers in all bathrooms
- Power outlets for air-conditioner in all bedrooms
- Power plug for cooking range, refrigerator, microwave ovens, mixer & grinder in kitchen
- Plug points for refrigerator TV and audio systems etc whenever necessary
- 20 Amps 3phase supply for each unit and individual meter boards
- Miniature circuit breakers MCB and ELCB for each distribution board of MDS / Mertigerin make
- All electrical fittings of MK/Northwest or equivalent make

HOT WATER SYSTEMS:

Solar Water heating system to be provided to individual units at extra cost.

COMMUNICATION SYSTEM:

- Telephone points & TV points in all bedrooms, drawing & dining areas
- Telephone cable with high speed CAT6 cable
- Provision for DTH TV service
- Video phone, intercom facility in all units connecting to security & amenities
- Internet provision in master bedroom and study room using CAT6 cable.
- Wi -Fi facility available near club house and park.

WHEN THE VISION IS INFINITE THE CREATION IS INFINITI

The venture of Vision Avenues is first class in every aspect. Not surprising really, considering that is the brainchild of an eminent Chartered Accountant with an eye for details.

Vision Avenues aims to create habitat that leaves no aspirations untouched. The location, the architecture, the planning and the amenities are uncompromisingly perfect so that those used to the world's finest will feel totally royale.

The accent has been on professionalism. The best architects, landscapers, club managers and engineers have been employed to match up to the highest standards of deliverables.





Vision Avenues Private Limited
101, Mahita Enclave, C-61, Madhura Nagar, Yousufguda Road, Hyderabad- 500 038,
Phone : +91-040-6678 5857/8, Fax No. +91-040-6678 5856, Email: info@visionavenues.com,
www.visionavenues.com

Architects

GENESIS
PLANNERS PVT. LTD.

Road No. 92, Jubilee Hills, Hyderabad - 5000 033
Phone : +91-040-2355 4366/2355 4377, Fax No. +91-040-2355 5549

Note: This brochure is only a conceptual presentation of the project and not a legal offering.
The developers reserve the right for any deletions/ additions in plans and elevations. All details are subject to
change and all optional amenities other than the above specifications are at extra cost.